

Contact Number: +1 512-522-2284
Email: info@avoradoors.com
Website: www.AvoraDoors.com
Address: Texas Facility
1309 Ave H Grand Prairie, TX 75050

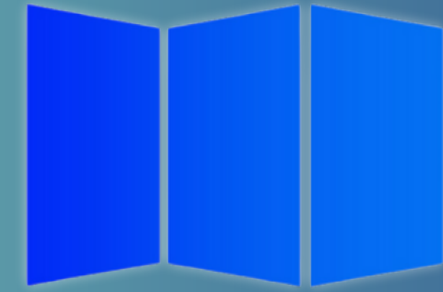

AVORA DOORS



INFO@AVORADOORS.COM

BUILDING SOLUTION RIGHT HERE FOR YOU



WATERPROOF PERFORMANCE

WATER TIGHTNESS AND AIR TIGHTNESS.
RESIST THE STORM, RAIN,
SAND AND DUST, AND CREATE A WARM
AND COMFORTABLE LIVING SPACE FOR YOU



THERMAL INSULATION PERFORMANCE

MULTI-CAVITY STRUCTURE OF
HEAT-CONDUCTING MATERIAL, WITH GOOD
THERMAL INSULATION PERFORMANCE, SAVING
UP TO 70% OR MORE ENERGY

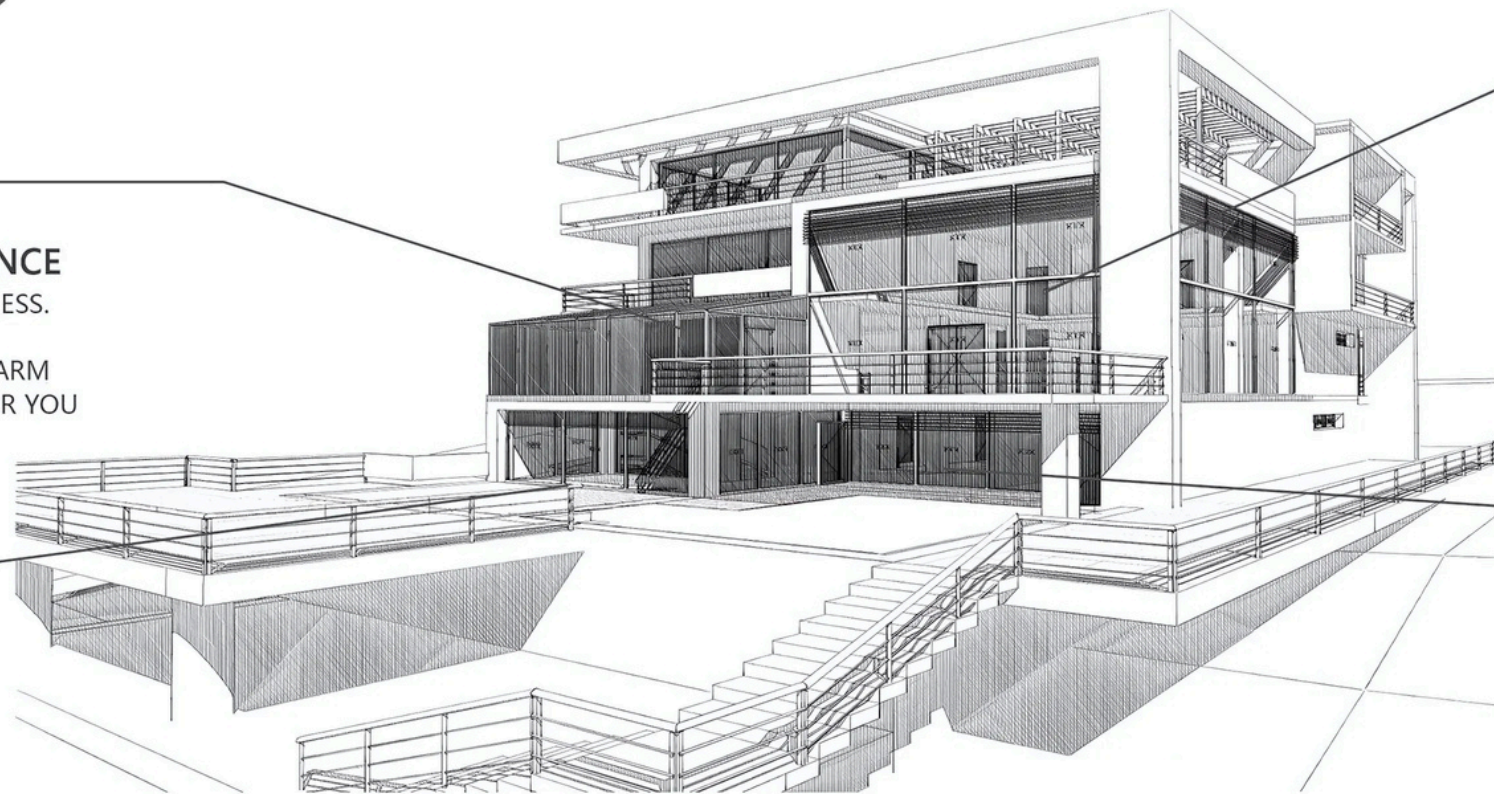

WIND PRESSURE RESISTANCE

WIND PRESSURE RESISTANCE
PERFORMANCE CAN REACH 9 LEVELS,
HIGH-STRENGTH WIND PRESSURE RESISTANCE
PERFORMANCE, CAN EASILY FACE
VARIOUS SEVERE NATURAL DISASTERS



SOUND INSULATION PERFORMANCE

MULTI-CAVITY STRUCTURE.
MANY COMPRESSION RUBBER SEALS.
THE SOUND INSULATION CAPACITY REACH 36DB.
EVEN IF YOU ARE IN A BUSY CITY,
YOU CAN STILL ENJOY TRANQUILITY AND COMFORT



AVORA DOORS

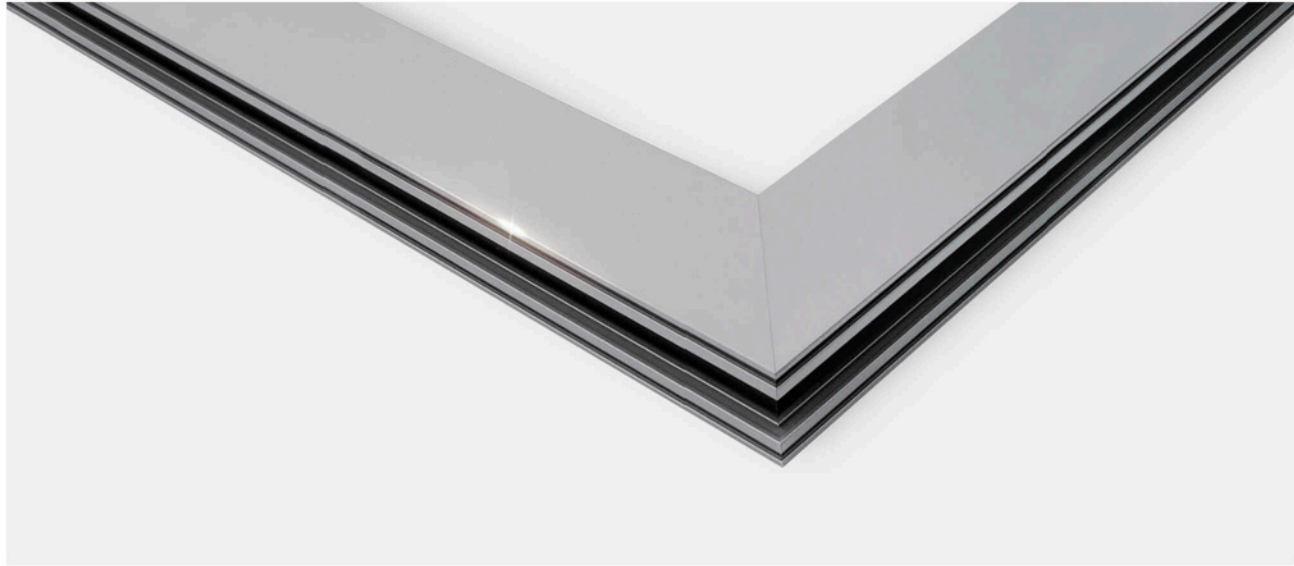

WIND RESISTANCE



WHEN CLOSED, THE FRAME JOIN IS ON THE SAME PLANE
IT IS NOT ONLY BEAUTIFUL AND GENEROUS,
BUT ALSO GREATLY ENHANCED AIR TIGHTNESS AND EXCELLENT WINDPROOF PERFORMANCE

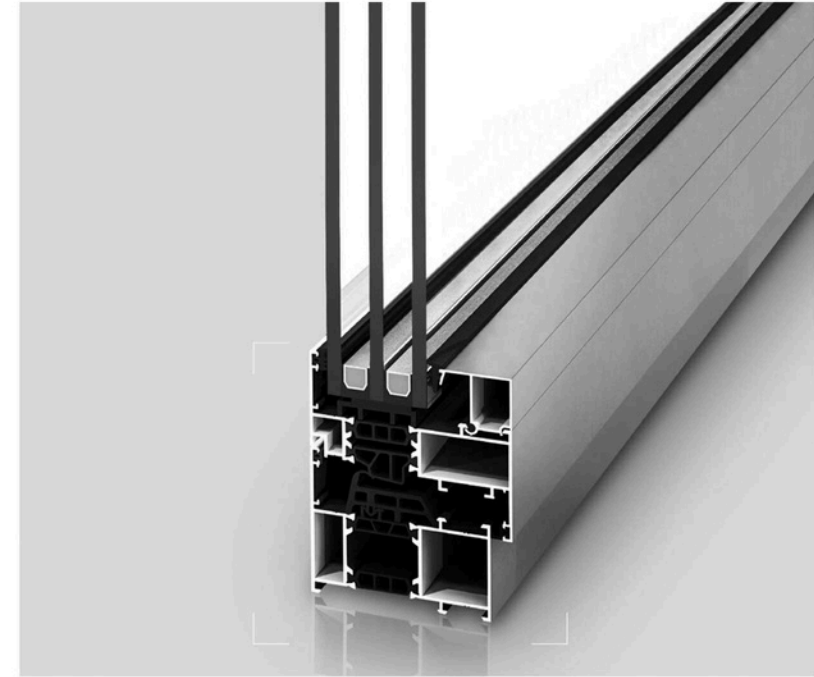

THERMAL BREAK SYSTEM



THE ENERGY-SAVING SYSTEM ADOPTS EUROPEAN STANDARD DESIGN, PROFILE
AND HARDWARE, PROFILE AND ACCESSORIES ARE PERFECTLY COMPATIBLE WITH SELF-CONTAINED SYSTEM



AVORA DOORS

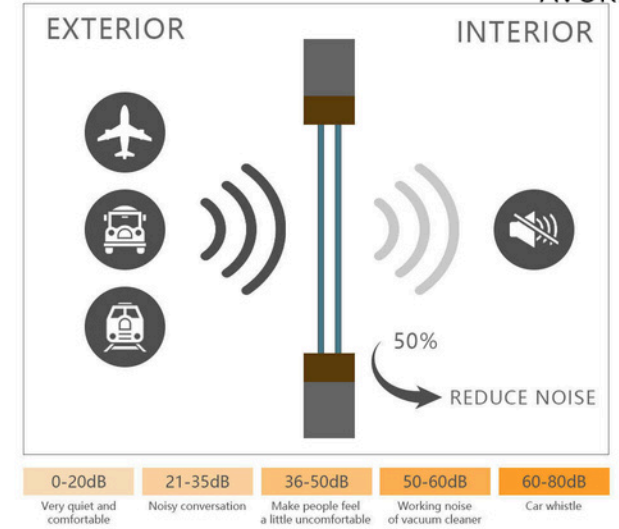
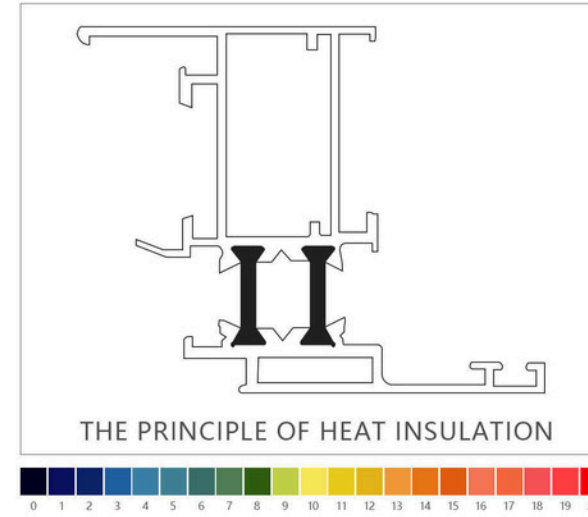

TECHNICAL ANALYSIS

Inspection of the dimensional accuracy of the heat insulation strip, follow up with the national standard GB/T236152009.

Detect and analyze the internal structure of the heat insulation strip, according to the national standard GB/T23615.1-2009.and Density test according to GB/T23615.1-2009.Use accurate electronic weighing to detect its density.

The value of the transverse tensile strength of the insulation strip, the impact strength without notch, Applying the national standard GB/T2361512-2009



AVORA DOORS

INSULATION STRIP

LEADING DOOR AND WINDOW INSULATION STRIPS EFFECTIVELY BLOCK HEAT CONDUCTION, SO AS TO ACHIEVE THE EFFECT OF HEAT PRESERVATION AND HEAT INSULATION
THE RUBBER STRIP HAS GOOD WEATHER RESISTANCE AND CORROSION RESISTANCE, AND THE SEALING RUBBER STRIP EFFECTIVELY BLOCKS THE AIRFLOW OF INDOOR AND OUTDOOR WATER.
PLAYED THE ROLE OF SOUND INSULATION AND WATER BLOCKING
USE THE PRINCIPLE OF PRESSURE BALANCE TO DRAIN WATER THROUGH THE DRAIN HOLE

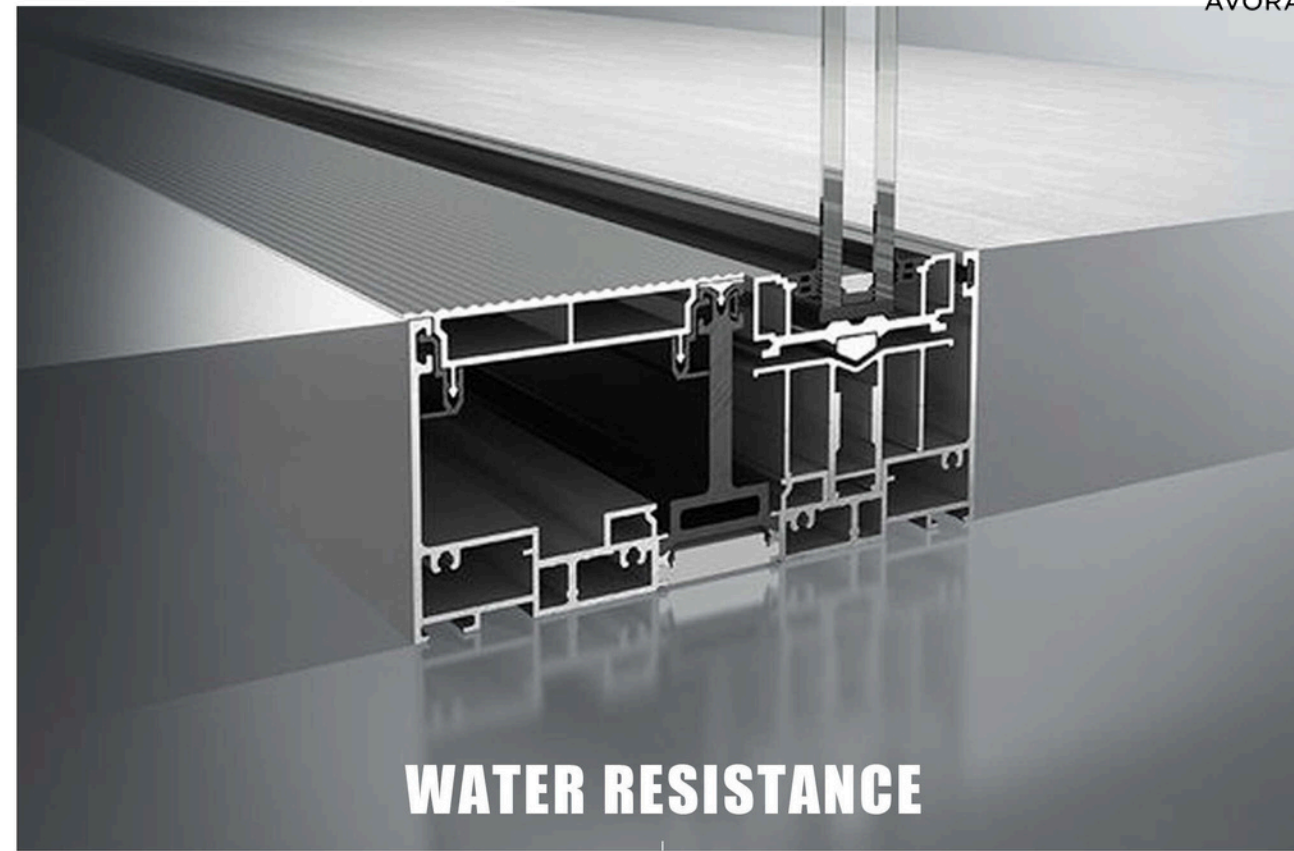

WATER RESISTANCE

ADOPTING A NEW WINDOW PLATE STRUCTURE, ADDING A DOUBLE DRAINAGE DESIGN FOR THE AUXILIARY FRAME, AND A DRAINAGE PORT ON THE OUTER FRAME SURFACE EFFECTIVELY SOLVE THE PROBLEM OF WIND AND RAIN INVERSION AND AVOID MILDEW ON THE WALL



TEMPERED GLASS

ENERGY-SAVING SEALED STRUCTURE TEMPERED HOLLOW GLASS,
WHICH CAN EFFECTIVELY BLOCK
THE CONDUCTION OF HEAT INSULATION, HAS THE EFFECTS
OF ENERGY SAVING, SOUND INSULATION, UV PROTECTION, AND ANTI-CONDENSATION

SINGLE GLASS

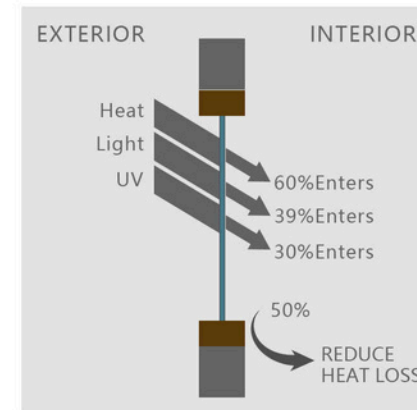

DOUBLE-LAYERED GLASS

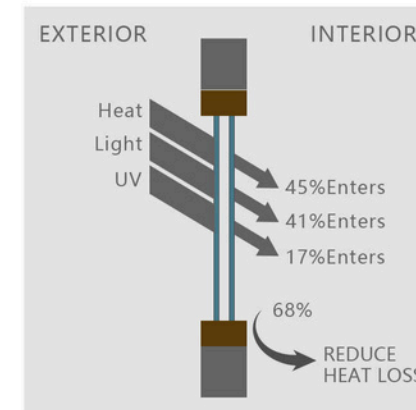

TRIPLE GLASS

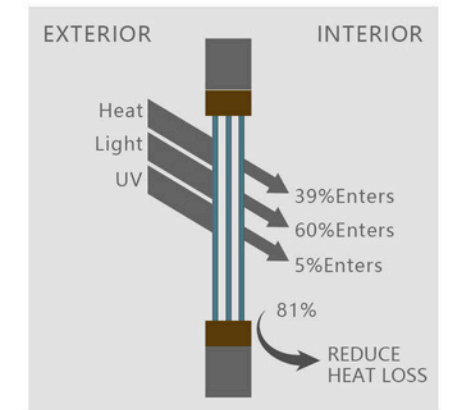

● **Energy Saving & Environmental Friendly**

APRO system with strong nylon thermal break design, which can protect the interior energy saving an environment protecting is superior. its integrated performance of the insulation, temperature control, waterproof etc is in the leading position in the industry of window and doors system

● **Super Durability**

With unique hardware, the system is perfectly compatible with the profile, with a high degree of precision, The opening times of the windows are 30,000 times, and the doors are 100,000 times, The system can ensure that there is no trouble and flexible use for more than 10 years

● **Exclusive Surface Treatment**

The weather resistance is very excellent by using exclusive surface treatment technology The surface finishing has anodizing, powder coating, electrophoresis etc, and rich color and grain to choose, which can meet all kinds of building design needs

● **High Intensity Extrusion Profile**

All window frame and sash are cavity structure, and the aluminum thickness is thicker than national standard; All aluminum alloy profile are aging treatment, intensity is far stronger than ordinary aluminum window and door.

● **Excellent Sealing Performance**

Adopting European standard ternary propylene sealant, automobile grade sealant, anti-aging for more than 10 years; For uniform composition and stable sealing performance, to ensure door and window's air tightness, water tightness and sound insulation energy work efficiently

● **Flexible Application Selections**

The same door and window profile section is used to apply different series of changes by changing the width of the middle insulation bar, so as to reduce the inventory pressure, It possess good ventilation, screen window, shading configuration

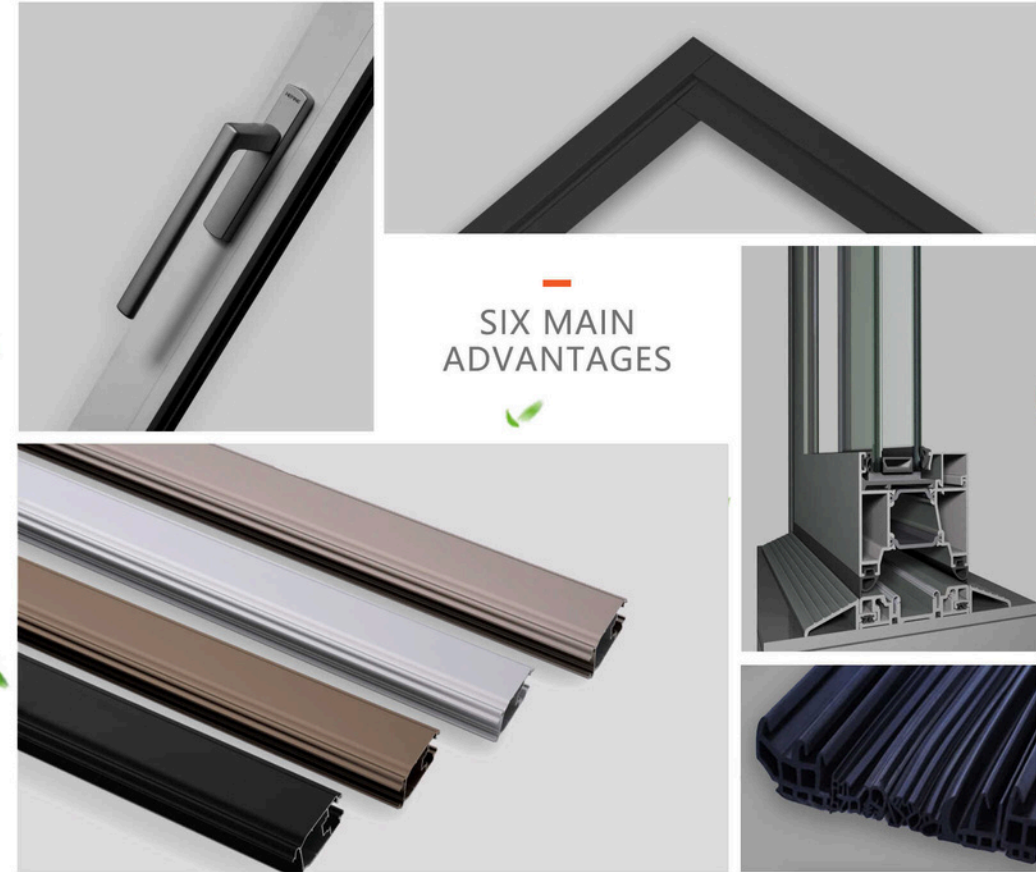



**MAIN
PRODUCTS**



FOLDING DOOR

Performance

Folding door system	Heat preservation performance(m ² K)	Sound insulation performance(dB)	Watertight performance(Pa)	Airtight performance	Wind resistance (KPA)
68 Series	2.5 1P×5	30 1P×3	350 1P×4	1P×7	3.0 1×5

Parameters

Folding door system	Visible surface(mm)	Section profile width (mm)	Build in glass thickness(mm)
68 Series	Upper rail 40 Frame 194 Bottom rail 36 Sash 52	Frame 34 Sash 94	19-24



- Adopting European Design Regular, effectively improve the performance of sound insulation and energy efficiency.
- Folding design can give the biggest clear opening and enjoy wide-open view.
- The weight capacity of bottom sliding track system can be 80KG, it will operate smoothly and effortlessly.
- Bottom rail design is with double waterproof rubber and drainage system, totally solve the problem of rubber ageing and leaking.



AVORA DOORS





SLIDING DOORS

Performance

Sliding door system	Heat preservation performance $W(m^2 \cdot K)$	Sound insulation performance (dB)	Watertight performance (Pa)	Airtight performance	Wind resistance (KPA)
139/210 Series	2.5 1P×5	30 1P×3	350 1P×4	1P×7	3.0 1P×5

Parameters

Sliding door system	Visible surface (mm)	Section profile width (mm)	Build in Glass thickness (mm)
139/210 Series	Upper rail 42 Frame 211 Bottom rail 39.5 Sash 55.6	Frame 35 Sash 94	19-24



- Adopting European design regular, effectively improve the performance of sound insulation and energy efficiency, prevent heat transfer, energy saving and comfort.
- Superior design for resisting wind pressure, can be used in Typhoon-prone area.
- Door frame is employed triple-cavity, which ensures a high-performance of rigidity; And independent drainage cavity ensures a smooth drainage under any circumstance.
- Stainless steel rail, single track, double tracks, triple tracks and 90 degree corner can be the options.
- Guide groove of door frame is with fission design, effectively prevent the door being prying off, and match multi-point lock design, thereby strengthening anti-burglary function.
- High quality aluminum alloy profiles and advanced finishing make it solid, durable, modern and fashionable.



SWING DOOR

Performance

Casement inside door system	Heat preservation performance(m ² K)	Sound insulation performance(dB)	Watertight performance(Pa)	Airtight performance	Wind resistance (KPA)
70 Series	2.5 1P×5	33 1P×4	350 1P×6	1P×7	3.6 1P×6

Parameters

Casement inside door system	Visible surface(mm)	Section profile width (mm)	Build in glass thickness(mm)
70 Series	Frame 46 Sash 102	Frame 69 Sash 78	24-28



- Use the equal pressure between the inner frame and outer frame, Use epdm polyurethane foam, Better for sealing performance and insulation performance.
- Door frame is employed triple-cavity, which ensures a high-performance of rigidity; And independent drainage cavity ensures a smooth drainage under any circumstance.
- High quality aluminum alloy profiles and advanced finishing make it solid, durable, modern and fashionable.
- The hinge install to side place, and the strong hardware around the door frame, The door more strong and security.





PIVOT DOOR

Parameters			
Pivot door system	Visible surface (mm)	Section profile width(mm)	Build in Glass thickness (mm)
AP46	top sash 63 bottom sash 100 frame 44	sash 46 frame 100	25



- Large glass and a minimal frame allow for more light and a modern style.
- The self-closing pivot hinge makes it possible to tailor make a pivot door up to 150 kg, that feels as light as a feather.
- allows the door to swing in all possible directions up to 360° with silent hold positions at -90° 0° + 90° .
- Adjustable 180° and 360° swing operation.



GLASS PARTITION

FRAME DESIGNS



SOLO



TRIO

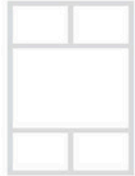

DUO-T

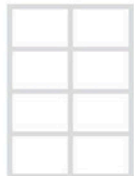

CONTINENTAL



PENTAGON



QUATTRO

- Visible frame size area available: 16mm, 18mm, 25mm, 32mm.
- Lightweight and requires only 3 pounds of pressure to slide open or close.
- Standard sizes include 610mm, 762mm, 914mm, 1016mm, wide and 2032mm, 2134mm, 2438mm high. Custom sizes available.
- Dust prevention strip comes standard.
- Optional divider strips add style and flexibility.
- Sound reduction strips are optional with various solutions.



AVORA DOORS



AVORA DOORS



SINGLE/DOUBLE HUNG WINDOW

Performance

Single/Double Hung window system	Heat preservation performance(m ² K)	Sound insulation performance(dB)	Watertight performance(Pa)	Airtight performance	Wind resistance (KPA)
UXC128	2.5 1P×5	30 1P×3	290	0.55 L/s·m ²	2880 Pa

Parameters

Single/Double Hung window system	Visible surface(mm)	Section profile width (mm)	Build in glass thickness(mm)
UXC128	Frame 63 Sash 45	Frame 55 Sash 40.8	16-27

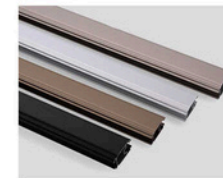

- Be suitable for both residential and commercial project
- Tilt-wash design makes it easy to clean
- Widely using in renovation project in the US and the UK. Can keep the original architectural style



CASEMENT OUTSIDE WINDOW

Performance

Casement outside Window	Heat preservation performance(m ² K)	Sound insulation performance(dB)	Watertight performance(Pa)	Airtight performance	Wind resistance (KPA)
60 Series	2.7 1P×5	30 1P×3	700 1P×6	1P×7	4.3 1×7
70 Series	2.5 1P×5	35 1P×4	700 1P×6	1P×7	4.8 1×8

Parameters

Casement outside Window	Visible surface(mm)	Section profile width (mm)	Build in glass thickness(mm)
60 Series	Frame 36 Sash 85	Frame 60 Sash 69	24-28
70 Series	Frame 36 Sash 85	Frame 69 Sash 78	24-28



- Adopting the European standard design, effectively improve the sound insulation effect and the overall insulation performance, and prevent indoor and outdoor hermal energy transmission, energy saving, environmental protection, comfort.
- Adopting complex three frames design, strong rigidity, with the independent drainage system, which makes the window drainage is smooth, and it does not have the rain water pouring.
- Choosing high quality aluminum alloy and advanced surface treatment, the whole window structure is stronger, more durable, beautiful and fashionable.
- By fitting different accessories can be applied to single tilt inside, single turn inside, or tilt and turn in a various of open ways.
- The rich configuration can install perfect ventilation, screen, shading.



AVORA DOORS



AVORA DOORS



SLIDING WINDOW

Performance

Sliding Window system	Heat preservation performance(m ² *K)	Sound insulation performance(dB)	Watertight performance(Pa)	Airtight performance	Wind resistance (KPA)
60 Series	3.3 1P×4	27 1P×2	650 1P×5	1P×5	3.0 1×5

Parameters

Sliding Window system	Visible surface(mm)	Section profile width (mm)	Build in glass thickness(mm)
60 Series	Frame 52 Sash 69	70 Hook 34 Frame 128 Sash 69	21-22



- Adopting European standard, Our system has a great performance in sound insulation and heat insulation, which mean energy-saving, environmental protection and comfort.
- Triple-cavity, strong rigidity, is a special drainage process to make the smooth drainage, no rain backflow.
- All rubber seals are indoor matching the multi-point lock which are firm and good security.
- High quality aluminum alloy profiles and advanced finishing make it solid, durable, modern and fashionable.
- Stainless steel track with screens could compose the series 60/70 casement windows.

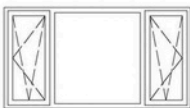

TILT AND TURN WINDOW

Performance

Tilt and Turn window	Heat preservation performance(m ² K)	Sound insulation performance(dB)	Watertight performance(Pa)	Airtight performance	Wind resistance (KPA)
128 Series	2.3 1P×6	32 1P×3	700 1P×6	1P×8	4.3 1×7
138 Series	2.3 1P×6	35 1P×4	700 1P×6	1P×8	4.7 1×7

Parameters

Tilt and Turn window	Visible surface(mm)	Section profile width (mm)	Build in glass thickness(mm)
128 Series	Frame 42 Sash 70	Frame 128 Sash 69	24-28
138 Series	Frame 42 Sash 70	Frame 136 Sash 78	24-35



- Adopting the European standard design, effectively improve the sound insulation effect and the overall insulation performance, and prevent indoor and outdoor thermal energy transmission, energy saving, environmental protection, comfort.
- Adopting complex three frames design, strong rigidity, with the independent drainage system, which makes the window drainage is smooth, and it does not have the rain water pouring.
- Choosing high quality aluminum alloy and advanced surface treatment, the whole window structure is stronger, more durable, beautiful and fashionable.
- By fitting different accessories can be applied to single tilt inside, single turn inside, or tilt and turn in a various of open ways.



AVORA DOORS



AVORA DOORS



BI-FOLD WINDOW

Performance

Folding window system	Heat preservation performance(m ² K)	Sound insulation performance(dB)	Watertight performance(Pa)	Airtight performance	Wind resistance (KPA)
50 Series	1.5 1P×8	30 1P×3	350 1P×6	1P×7	3.0 1×5

Parameters

Folding window system	Visible surface(mm)	Section profile width (mm)	Build in glass thickness(mm)
50 Series	Upper rail 40 Frame 194 Bottom rail 36 Sash 52	Frame 34 Sash 94	19-24

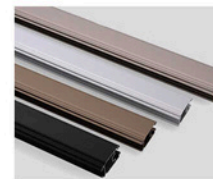

- Bi-fold window mainly used applied to shopping center, office building exhibit hall, house.
- Bi-fold window is elegant in appearance, novel in style, various in colors and easy to use.
- Bi-folds are a popular and versatile window. They have wide opening to maximize views and airflow, and these stylish windows show an expansive feeling to the house.



BI-FOLD WINDOW

Performance

Folding window system	Heat preservation performance(m ² *K)	Sound insulation performance(dB)	Watertight performance(Pa)	Airtight performance	Wind resistance (KPA)
50 Series	1.5 1P×8	30 1P×3	350 1P×6	1P×7	3.0 1×5

Parameters

Folding window system	Visible surface(mm)	Section profile width (mm)	Build in glass thickness(mm)
50 Series	Upper rail 40 Frame 194 Bottom rail 36 Sash 52	Frame 34 Sash 94	19-24



- Bi-fold window mainly used applied to shopping center, office building exhibit hall, house.
- Bi-fold window is elegant in appearance, novel in style, various in colors and easy to use.
- Bi-folds are a popular and versatile window. They have wide opening to maximize views and airflow, and these stylish windows show an expansive feeling to the house.



AVORA DOORS





CURTAIN WALL

Parameters				
Curtain wall System	Spec	Color	Thickness	Installation
Glass curtain wall	Double glass Triple glass Single glass Laminated glass	Clear Tinted Reflective	5mm-42mm	Embedded Hang out

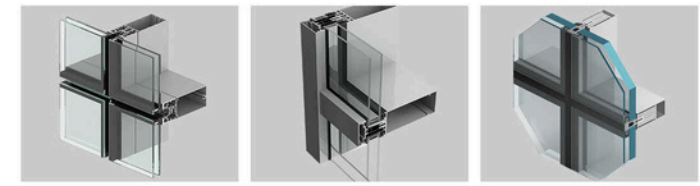

- With APRO facade solutions you can create that unique signature design for your façade and add an enhanced sense of character to any building.
- Are available in different energy levels, from non-insulated to super high insulating or suitable for passive construction.
- APRO has experts team ready to provide tailored, on-demand product solutions to help realize any project, no matter its size, scope or complexity.
- Provide one-step service, from designing, supplying to installing



ALUMINUM CURTAIN WALL

Parameters

Aluminum Panel System	Surface Finishing	Thickness (mm)	Aluminum panel
Aluminum Panel	Powder Coating PVDF Anodized	1.0-3.0	Aluminum Panel or Aluminum Composite Panel

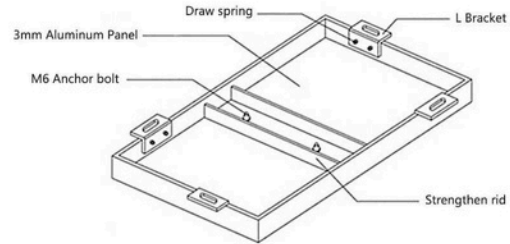

- Aluminium panels are a great durable material for creative solutions.
- Have a very low cost of maintenance, no rusty.
- Come in wide variety of colours, shapes and sizes.
- It's versatile enough for the most stunning and inventive designs.

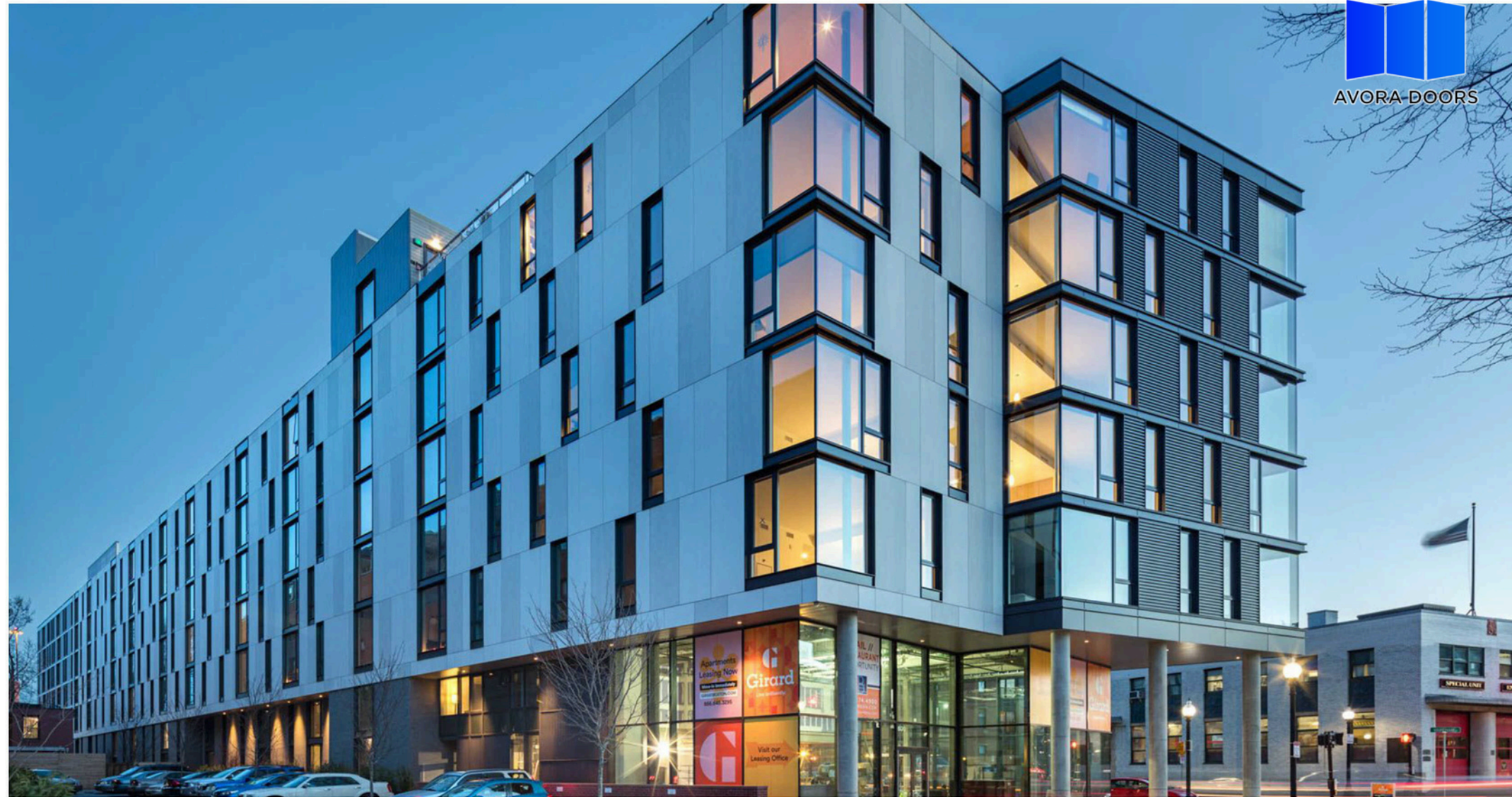



LOUVER

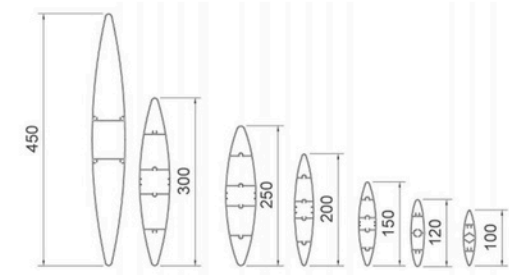

Parameters

Blade shape	Airfoil	Flat	Z shape
Operation	Fixed	Adjustable	Manual /Motorize
Blade Size Option	60mm/100mm/120mm/150mm /200mm/250mm/300mm450mm		
	60/90mm/115mm/150mm/250mm		

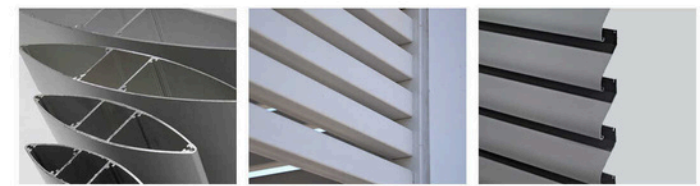



PERGOLA

Details

Specification	Size	Alu Wall Thickness	Color
Blades	200*40mm	1.8mm	Black
Post	110*110mm	2.0mm	White
Beam	220*65mm	2.0mm	Gray

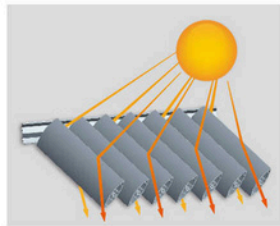

Angle open- Sun shading ventilation

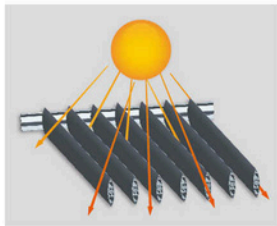

Fully Open-Ventilation

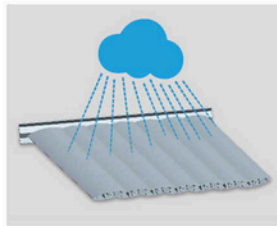

Closed Rainy





AVORA DOORS

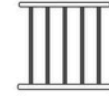

ALUMINUM HANDRAILS

Parameters

Width(mm)	height(mm)	space(mm)	structure	Mount way
1500mm(maximum)	1020mm 1200mm customized	120mm(maximum)	welded screwed	under ground flush

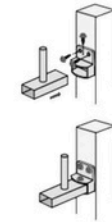

SHROUD DETAILS

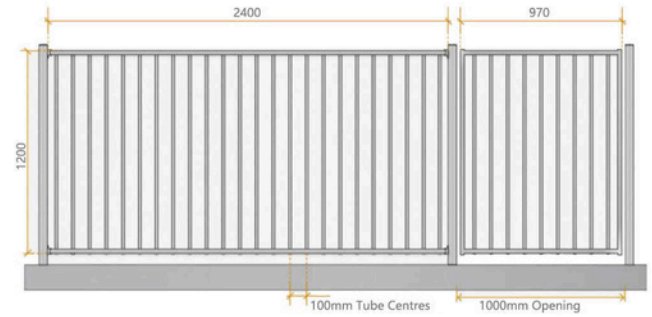

- The structure of the aluminum tubar railing is simple and modern.
- The aluminum alloy profile is made of thick pipe, which is beyond the scope of traditional guardrail, and the overall structure is stable and firm.



ALUMINUM GLASS BALUSTRADE

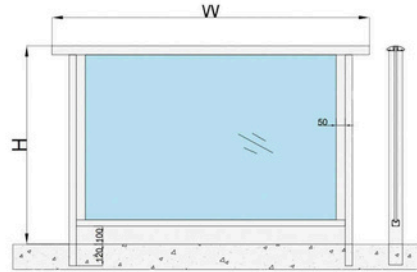

Handrail options

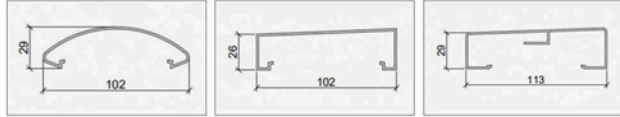

- Frame your view with elegance, using sleek and modern Glass Railing Handrail.
- Constructed with only the highest quality materials, our handrails offer clean lines and minimal disruption.
- Brackets, joints, and mounting materials have been carefully designed to keep the focus on the beauty around you, not the hardware.
- Glass handrail will make your house beautiful.



AVORA DOORS



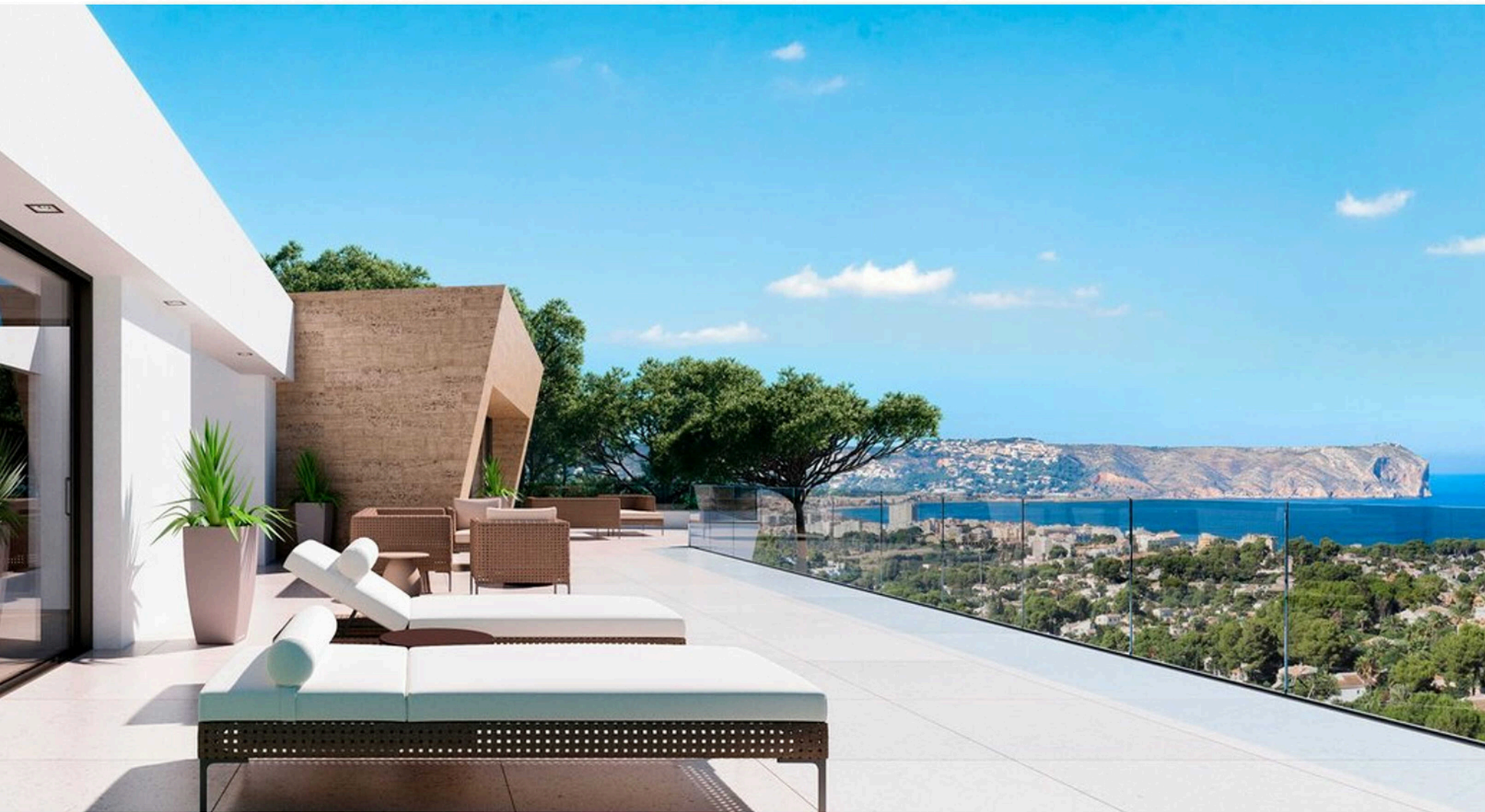

GLASS HANDRAIL

Aluminum U-shaped trough railings are specially designed for high-end hotel balconies and apartments.

We use high-quality laminated tempered glass and high-quality accessories, long service life.

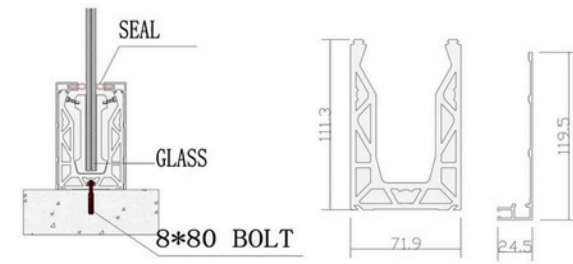

- Aluminum tempered frameless u channel for designs balcony glass railing puts the outer surfaces into compression and the inner surfaces into tension.
- Such stresses cause the glass, when broken, to crumble into small granular chunks instead of splintering into jagged shards as plate glass.

-ENGINEERING CASE-



AVORA DOORS

CASE DISTRIBUTION

THE COMPANY MAINLY SELLS TO SOUTHEAST ASIA, AUSTRALIA AND OTHER REGIONS
THERE ARE LARGE-SCALE ENGINEERING PROJECTS IN VARIOUS REGIONS OF THE WORLD, SUCH AS:
URUGUAY PPP2 PROJECT, PANAMA LAGOON VILLAS PROJECT,
GHANA AIRPORT HILL VILLA PROJECT, THAILAND PATTAYA RESORT HOTEL PROJECT, ETC.

- LARGE PROJECT
- SMALL PROJECT



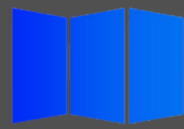

AVORA DOORS

-COMMERCIAL-

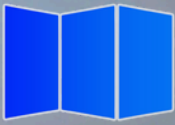

AVORA DOORS



PRODUCT PARAMETER

Product Name: Sliding Window
Product Color: Black
Glass Specification: Tempered Glass



- Year: 2018
- Quantity: 1300 sqm
- Product: Window&Door
- Project: Football Club
- Location: Angola
- Client: Architect

- Year: 2021
- Quantity: 753 sqm
- Product: Interior Hinge Door
- Project: Marriott Hotel
- Location: Florida, US
- Client: Contractor

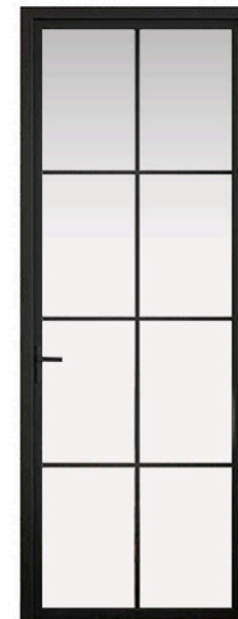

PRODUCT PARAMETER

Product Name: Swing Door
Product Color: Black
Glass Specification: Tempered Glass



AVORA DOORS



YEAR	QUANTITY	PRODUCT	LOCATION	CLIENT	PROJECT
2018	350 SQM	WINDOW&DOOR	TRINIDAD AND TOBAGO	CONTRACTOR	SCHOOL PROJECT

- Year: 2017
- Quantity: 700 sqm
- Product: Curtain Wall
- Project: Hospital Project
- Location: Kansas, US
- Client: Owner

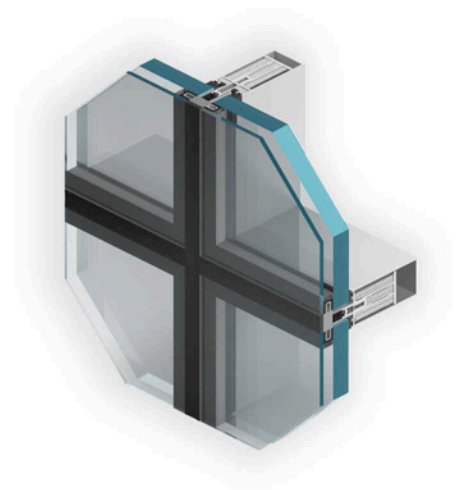

PRODUCT PARAMETER	Product Name: Curtain Wall Glass Color: Double Silver Low-e Glass Sealant: Silicone Sealant
-------------------	---



YEAR	QUANTITY	PRODUCT	LOCATION	CLIENT	PROJECT
2020	837 SQM	CURTAIN WALL	KINSTON, JAMAICA	TRADING COMPANY	GOVERNMENT BUILDING



AVORA DOORS



Year: 2019

Quantity: 950sqm

Product: Window&Door

Project: Resort Project

Location: Panama

Client: Developer



YEAR	QUANTITY	PRODUCT	LOCATION	CLIENT	PROJECT
2020	7000 SQM	WINDOW&DOOR	URUGUAY	CONTRACTOR	PPP2 PROJECT



AVORA DOORS



AVORA DOORS



YEAR	QUANTITY	PRODUCT	LOCATION	CLIENT	PROJECT
2020	7000 SQM	WINDOW&DOOR	URUGUAY	CONTRACTOR	RESORT PROJECT



AVORA DOORS

YEAR	QUANTITY	PRODUCT	LOCATION	CLIENT	PROJECT
2015	550 SQM	LOUVER	SYDNEY, AUSTRALIA	OWNER	HOTEL PROJECT



AVORA DOORS



YEAR	QUANTITY	PRODUCT	LOCATION	CLIENT	PROJECT
2017	1200 SQM	CURTAIN WALL	CAMEROON	OWNER	COMMERCIAL BUILDING

-RESIDENTIAL-

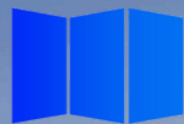

AVORA DOORS





AVORA DOORS



YEAR	QUANTITY	PRODUCT	LOCATION	CLIENT
2020	83 SQM	WINDOW&DOOR	THE US	OWNER

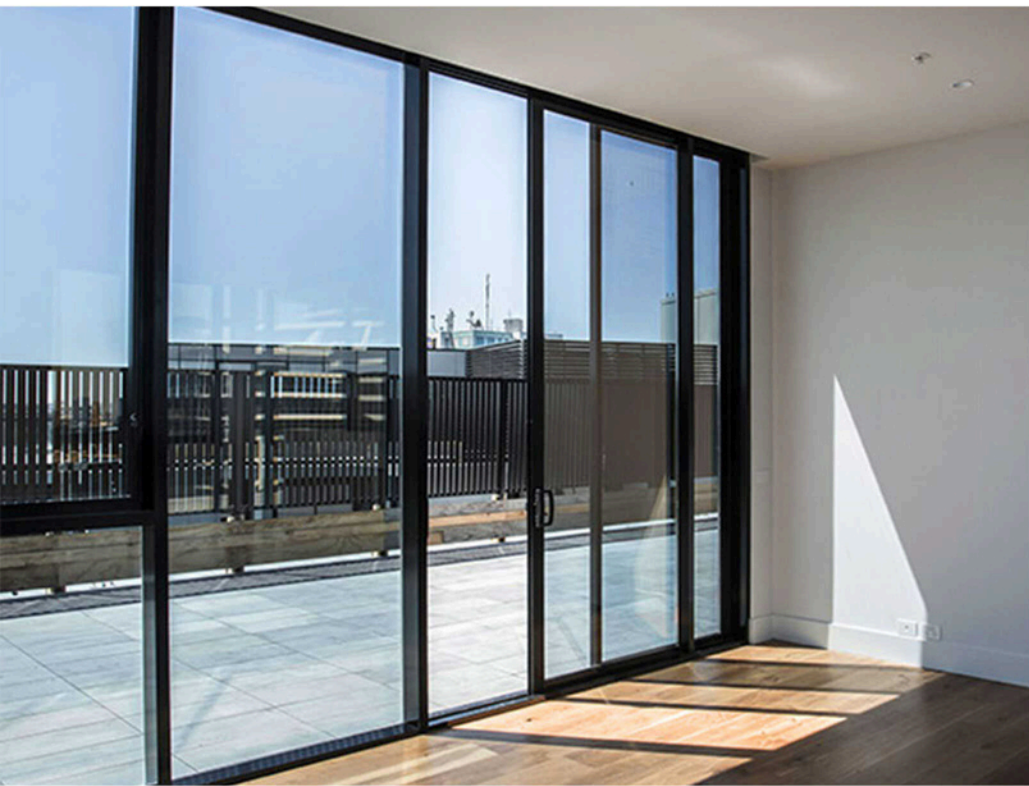

YEAR	QUANTITY	PRODUCT	LOCATION	CLIENT
2019	750 SQM	WINDOW&DOOR	MELBOURNE	DEVELOPER



AVORA DOORS



AVORA DOORS



YEAR	QUANTITY	PRODUCT	LOCATION	CLIENT
2019	120 SQM	WINDOW&DOOR	AUSTRALIA	OWNER



AVORA DOORS

- Year: 2017
- Quantity: 850 sqm
- Product: Window&Door
- Location: Peru
- Client: Contractor

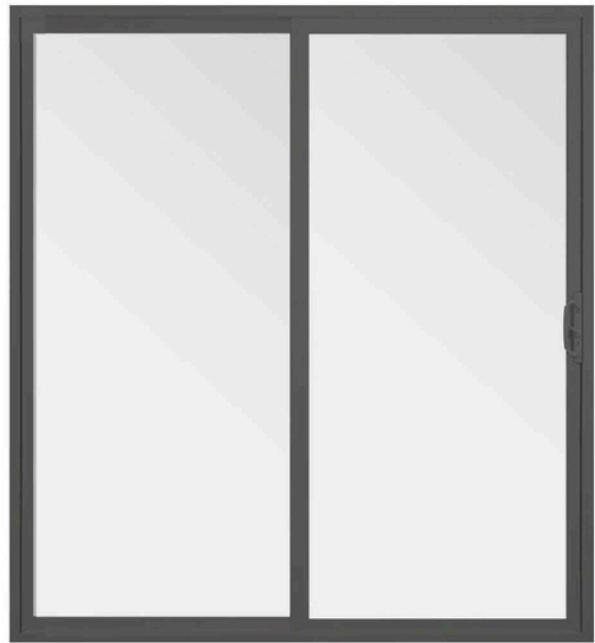

PRODUCT PARAMETER

Product Name: Sliding Door
Product Color: Black
Glass Specification: Double Layer





AVORA DOORS



YEAR	QUANTITY	PRODUCT	LOCATION	CLIENT
2018	260 SQM	WINDOW&DOOR	NIGERIA	ARCHITECT



YEAR	QUANTITY	PRODUCT	LOCATION	CLIENT
2016	600 SQM	WINDOW&DOOR, HANDRAIL	SYDNEY	DEVELOPER



AVORA DOORS



AVORA DOORS

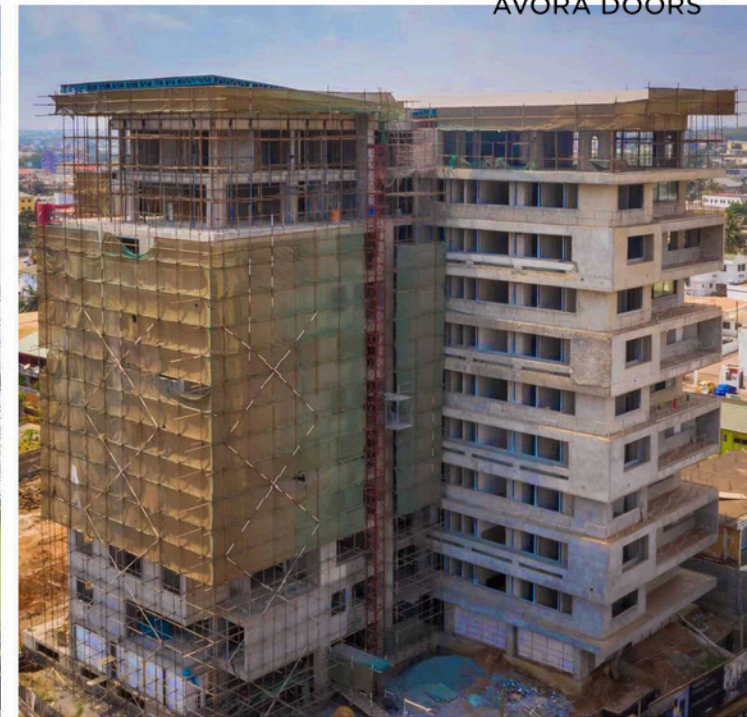

YEAR	QUANTITY	PRODUCT	LOCATION	CLIENT
2018	1000 SQM	WINDOW&DOOR	GHANA	CONTRACTOR

- Year: 2017
- Quantity: 460 sqm
- Product: Window&Door
- Location: Ghana
- Client:Owner

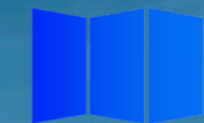

AVORA DOORS



PROFESSIONAL SERVICE

HERE, YOU CAN ENJOY YOUR RIGHTS AND GET THE BEST SERVICE FROM THE THREE ASPECTS OF PRE-SALE, SALE AND AFTER-SALE, WE WILL GUIDE YOU TO CLEAR YOUR CONFUSION AND LET YOU CHOOSE THE PRODUCT YOU LIKE BY KNOWING THE KNOWLEDGE PRINCIPLE YOU WANT TO KNOW, WELCOME TO CONTACT US!



UNDERSTAND BUYER NEEDS



PROVIDE PROFESSIONAL KNOWLEDGE ANSWERS



DESIGN SOLUTION



VISIT THE FACTORY



VISIT THE EXHIBITION HALL



GUIDE TO CHOOSE PRODUCTS



CUSTOMER CONFIRMS THE ORDER



INSTALLATION GUIDE



GET THE WARRANTY



AVORA DOORS



“ TAKE EVERY CUSTOMER SERIOUSLY ”

